

Work Instruction Number 109 - "Workforce in Road" signs (**Relaxation Works**)  
 All Amberon Traffic Management Installations or Removals on any main road or  
 approaching road works 40mph and above\* (unless the site specific risk  
 assessment deems it necessary on lower speeds of 40mph) must display the  
 "Workforce in road Slow" sign, this being the 1st Sign out and last sign in.

**WORKFORCE  
 IN ROAD  
 SLOW**

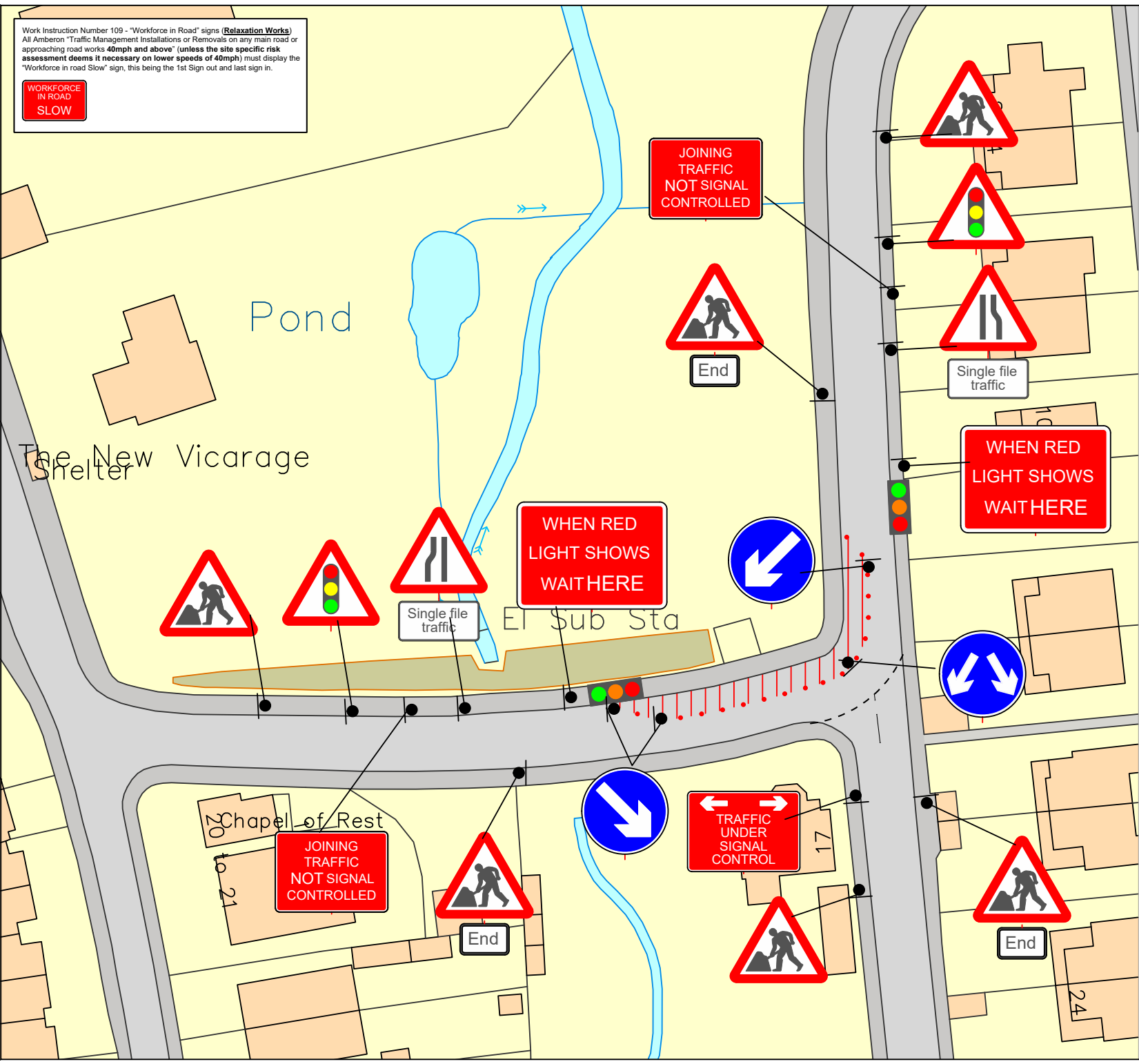

**TRAFFIC MANAGEMENT NOTES:**  
 1) All temporary traffic management shall be in accordance with Chapter 8 of the Traffic Signs Manual 2009.  
 2) All temporary traffic management shall be in accordance with the Traffic Signs (Amendment) (No. 2) Regulations and General Directions 2016.  
 3) All temporary traffic management shall conform to the Safety at Street Works and Road Works, A Code of Practice.  
 4) All temporary traffic management signs should be located 450mm min from the kerb face.  
 5) All temporary traffic management sign locations are indicative and are subject to on site approval from the Engineer.

**DETAIL B (Lead in taper) (B)**  
 Single Carriageway 40mph or less - 750mm traffic cones, spacing 1.2m.  
 Single Carriageway 50mph or more - 750mm traffic cones, spacing 1.2m.

Notes:  
 1) During darkness, warning lights to BS EN 12352:2006 should be provided in accordance with Table A1.3 (Appendix 1).  
 2) 45° tapers have 1.2m spacing, no relaxations.

**DETAIL C1 (Longitudinal Run) (C1)**  
 Single Carriageway 40mph or less - 750mm traffic cones.  
 Single Carriageway 50mph or more - 750mm traffic cones.

Notes:  
 1) During darkness, warning lights to BS EN 12352:2006 should be provided in accordance with Table A1.3 (Appendix 1).  
 2) For relaxation to Detail C1 see Table A1.3 (Appendix 1).

**SAFETY ZONE DIMENSIONS**  
 Permanent speed limit 30mph or less  
 Sideways safety zone 0.5m  
 Longways safety zone 0.5m  
 (Dimensions are minimal)

**Traffic Signal Head Timings**

Phase 1	Phase 2
Green 35 sec	Green 35 sec
Red 05 sec	Red 05 sec

**Key**

	Traffic sign
	Traffic cone/cylinder
	Traffic signal
	No waiting cone
	Pedestrian barrier
	Pedestrian signal

Checked by: DAVE MOORE  
 Customer: WWU  
 Job Reference: 3001603185  
 Location: ST BRANNOCKS ROAD, EX34 9NG  
 Date: 08/08/2022  
 Description: 2 Way Lights  
 Scale: NTS

Amberon Ltd  
 Tel: 0845 371 5050

Produced By: SCOTT RICHARDSON  
 Drawing Ref: 08/08/2022 - SR - 3434  
 This Drawing is subject to Copyright and remains the property of Amberon Ltd.

**Amberon Ltd**